

 neofect

Neomano Quick Guide

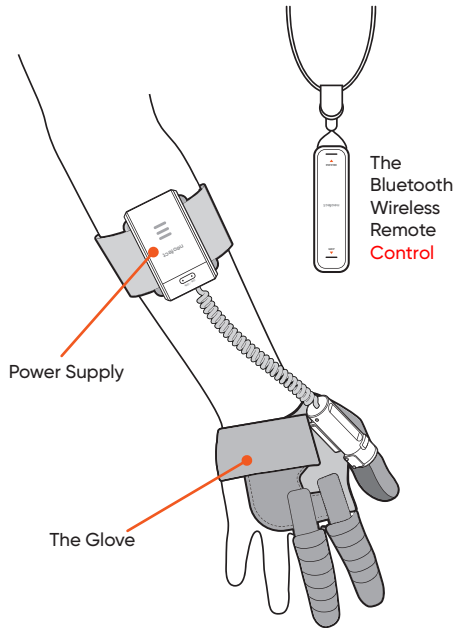

Component



- * Batteries are not included.
- * If cleaning is needed after use, wipe the glove with a dry cloth. Do not wash or use wet materials to clean.

Get User Guide support on
<https://www.neofect.com/>

Instructions for Use



1. Put the Neomano Glove on your hand.
*Attach the finger strap to the back of your hand with a moderate tension.



2. Press the ON/OFF button on the power supply to turn on the device. Hold the ON/OFF button on the power supply for 3 seconds to turn off the device.



3. Hold the **1** GRIP button on the remote control to grab an object. The **2** RELEASE button on the remote control to let the object go

*If you feel discomfort at any point, press the ON/OFF button on the power supply to immediately release any tension.

How to Reattach Motor to New Glove:

*The glove can be replaced if necessary.

Part1. Removing the old glove



1. Turn off the device.
2. Grab the motor and glove in each hand, and slide the motor body down to detach the motor from the cradle.



3. Remove the clip from the motorhead.



4. Pull the motorhead away from the motor body to separate the head and body, then remove the old glove.

Part2. Connecting the new glove



1. Make sure the **2** grooves of the new glove's **1** motorhead and the motor body are aligned, then connect the motorhead to the motor body.



2. Ensure the wires and Neomano logo are facing opposite sides, and place the clip onto the new motorhead to secure the head and body.



3. Align the side rail of the cradle to the bracket on the glove, ensuring the wires don't get stuck in-between.
4. Slide the cradle upwards to assemble. Done!

Cautions

General Usage

1. Discontinue glove use if you have a wound, rash or eczema on your skin, or a blood circulation disorder.
2. Do not wear while asleep.
3. During or after the use of the glove, if you are experiencing pain or developing a rash, please consult with a physician.
4. Store the glove in a location with low humidity and avoid direct sunlight.
5. When caring for the product, do not machine wash or dry, iron, or dry clean.
6. Do not use in a location with moisture, or a location where the device may get wet. This may damage the device or cause electrical damage.
7. This product is a medical device.
8. The wire, when exposed, may catch your hand or an object.
9. Use the correct size of the glove to avoid pain or malfunction.
10. Do not grab slippery or fragile objects.
11. Keep the control unit dry and away from heat.

Contraindications

1. Not for use with clients exhibiting increased tone/spasticity.
2. Not for use over wounds and infected areas.
3. Not for use with severe edema.
4. Not for use with severe contractures or joint deformities in the finger.
5. Before using the Neomano, a mild hand warm-up is recommended.

Battery Usage

1. Do not insert the batteries with the polarities incorrectly aligned.
2. **Use both of "AA" and "AAA" alkaline or rechargeable batteries with this device. Do not use other types of batteries. Do not use new and used batteries together.**
3. Remove the batteries if the device will not be used for three or more months.

Specification

Glove

Glove Material	Leather, Velcro, Rubber Non-slip cloth
Wire Material	Synthetic Thread
Holding Power	2kg (20N)
Strap Material	Neoprene
Thumb Splint Material	Aluminium

Power supply

Voltage	3.6v	
Power Source	Alkaline/AA X 3	
Size	51 X 95 X 30 mm	
Weight	65g(without batt.)	
Running Time	Battery	Max. 11h 30m
	Rechargeable	Max. 23h 30m

Remote Control

Power Source	Alkaline/AAA X 2
Size	31.5 X 100 X26 mm
Weight	39g (without batt.)
Running Time	Max. 150 days

Inspire hope

Everyone has their own goals in life, but the ultimate goal is the same: "To live a happy life"

Neofect believes that a happy life begins with finding purpose and is achieved through active participation and engagement in the things we love.

However, unforeseen circumstances may disrupt your happiness. Illness, aging, and accidents are a part of life. It is not uncommon to feel discouraged or defeated when met with these obstacles.

Neofect exists for those who strive for the best life they can possibly live.

Using breakthrough research and innovative technology, we can help you rediscover your purpose and live your best life.

Let us help you live your life on your own terms. You deserve it.

Neofect Neomano

Neomano is a robotic glove that enables people with hand paralysis to perform daily activities by providing powered grasp assist to maintain grip, followed by allowing passive release. Neomano helps people gain confidence in performing everyday tasks.

Neofect USA, Inc.

530 Howard St #100, San Francisco, CA 94105

Tel 888-623-8984

Email info@neofect.com

Neofect Germany GmbH

Marcel-Breuer-Str. 15, 80807 Munich, Germany

Tel +49 89-59081302

Email info@neofect.de